

SPK

SPK can be applied by hand for trials or for laboratory, media and show samples.

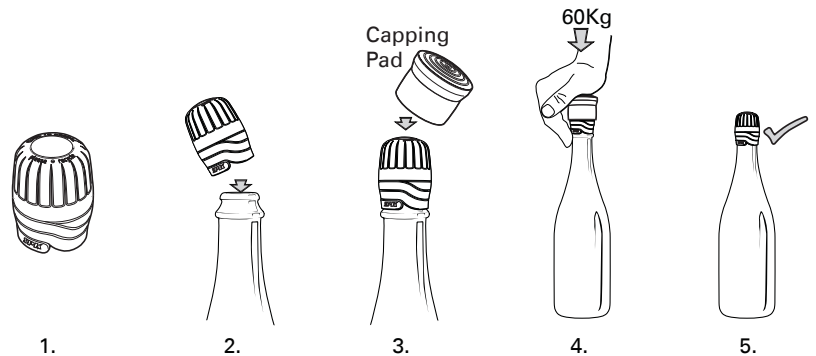

INTRODUCTION

SPK is a 'peel and reseal' closure for sparkling wines. It provides a quality, taint free, convenient solution using standard industry bottles.

SPK samples can be hand applied using a manual capping pad to test its unique functionality and performance. This method is only recommended for very small sample runs.

Glass

(Refer SPK Glass Fact Sheet 4.2)
Please ensure you use the correct glass for the closures you have been supplied. The closure will not function correctly if used with incompatible glass.

INSTRUCTIONS

1. Confirm cap size matches the bottle finish.
2. Place the closure onto the top bead of the bottle.
3. Firmly press the cap onto the bottle with the palm of your hand ~60Kg. Ensure to keep the cap square during application.
4. Check the closure is fully on the bottle.

CAUTION

This method should only be used for aesthetic samples and is not recommended for technical trials or saleable product.

ZORK

7 Hackney Road
Hackney SA 5069
t +61 8 8363 5635
e info@zork.com.au
w zork.com.au